



Adaptive
DISPLAY SOLUTIONS

Replacement Part Instructions

LED Display Module

For Use in A Series Signs

Part Numbers:
1763500101SP - 8 mm
1766500101SP - 16 mm
1767500101SP - 20 mm

Tools you will need

For 16 mm and 20 mm signs

#2 phillips head screwdriver

For 8 mm signs

Torque wrench with
2.5 mm hex tool

Adaptive LED Display Module
Masking Tool (62680026)

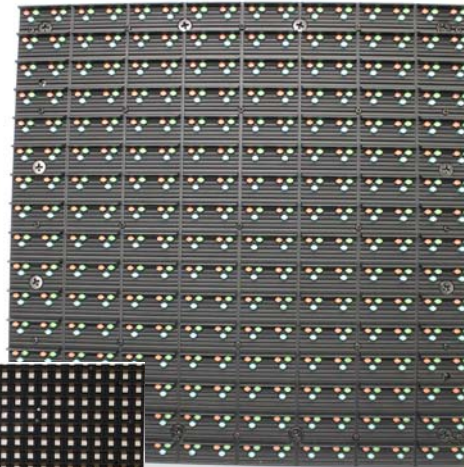

16 and 20 mm LED display module

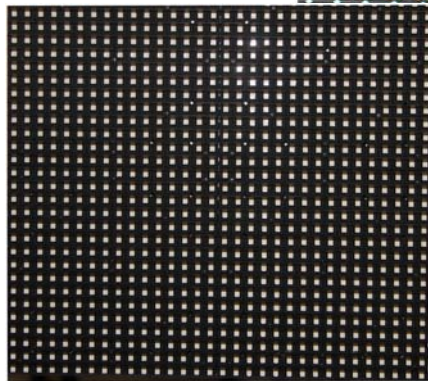

8 mm LED display module

WARNING

Hazardous voltage. Contact with high voltage may cause death or serious injury.
Always disconnect power to unit prior to service.

REMOVE POWER FROM THE SIGN

■ Remove power from the sign

Always remove power from the sign at the source.

■ Locate the LED display module

The entire front of the sign is covered with LED display modules.

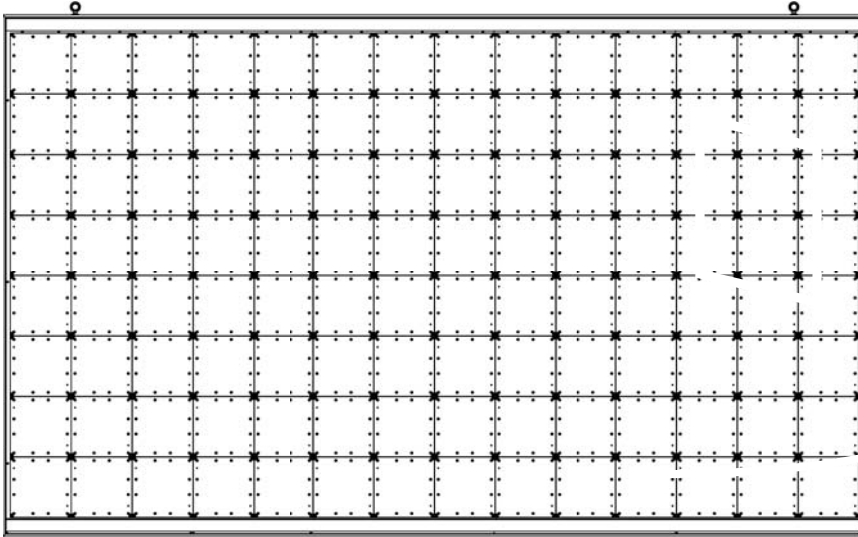

■ 16 mm and 22 LED display modules

Remove the LED display module

1. Use a #2 phillips head screwdriver to loosen the captive screws, located on the perimeter of the LED display module.

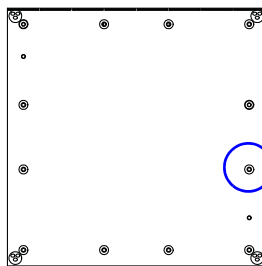

16mm LED display module

There are 12 captive screws on each 16mm LED display module.

There are 16 captive screws on each 20mm LED display module.

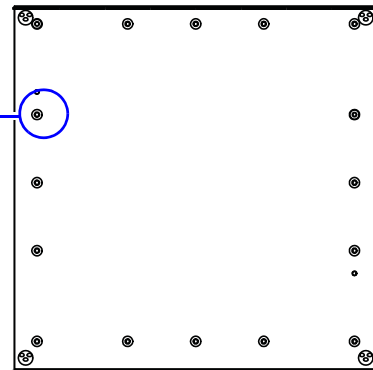

20mm LED display module

2. Pull the LED display module toward you.

3. Disconnect the communication cables and then the power cables.

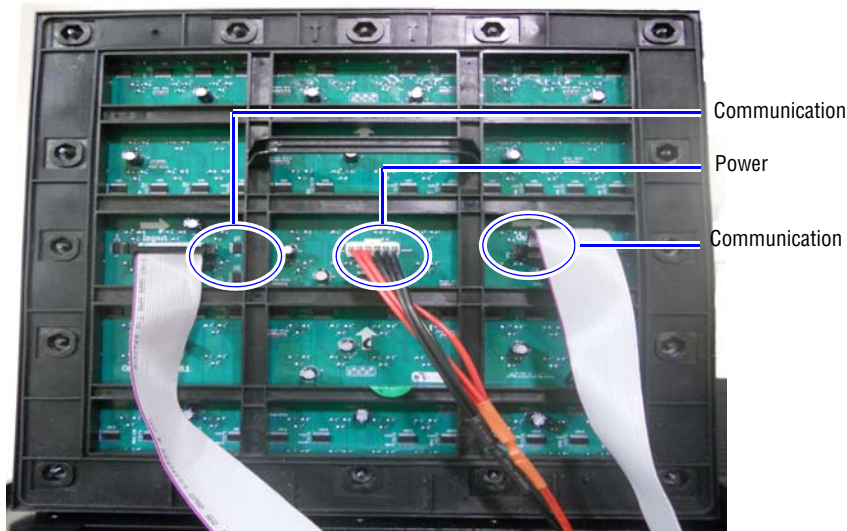

Install the replacement LED display module

1. Connect the connect the power cables and then the communication cables.
2. Close the LED display module.
3. Replace the screws.
4. Connect power to the sign.

■ 8 mm LED display module

Remove LED display module

1. Use the supplied LED Display Module Mask Tool to locate the screws to be removed. Directions for using the mask tool are also imprinted on the mask tool.
2. Place the mask tool over the LED display module to be removed.

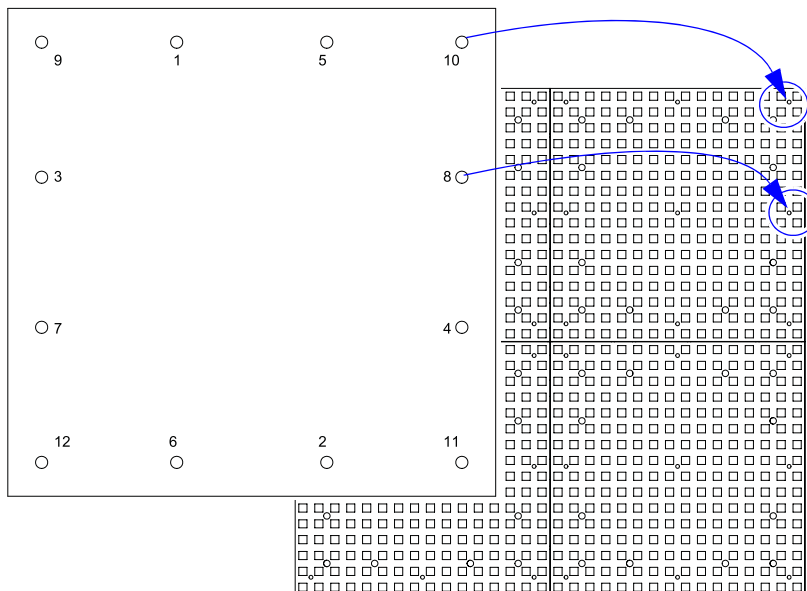

3. Position the mask so the 12 holes in the mask align with the 12 holes on the LED display module.
4. Use a torque wrench with a 2.5 mm hex key to loosen each screw in descending order of the numbers on the mask.
5. Remove the mask from the sign.

6. Pull the LED display module toward you.
7. Disconnect the communication cable and then the power cables.

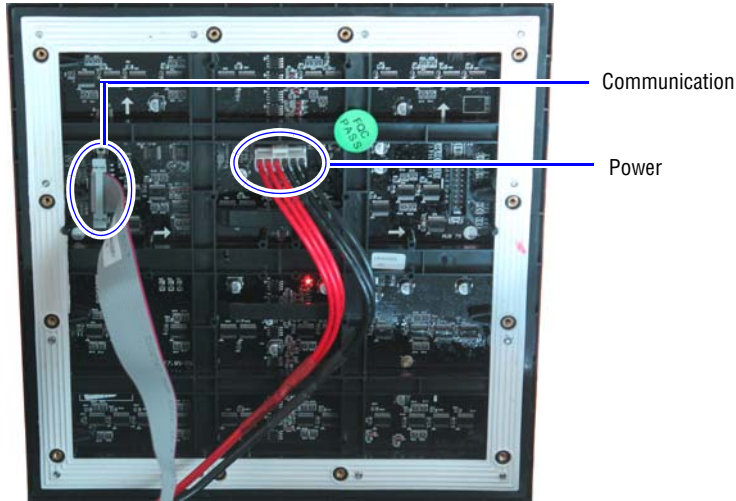

Install the replacement display module

1. Connect the power cables and then the communication cable to the back of the LED display module.
2. Place the LED display module into position on the sign.
3. Position the LED mask tool over the LED display module so the 12 holes in the mask align with the 12 holes on the LED display module.
4. Use a torque wrench with a 2.5 mm hex key, and set to 4.5 inch-lbs to tighten each screw in the order of the numbers on the mask. Position the torque wrench perpendicular to the mask tool.

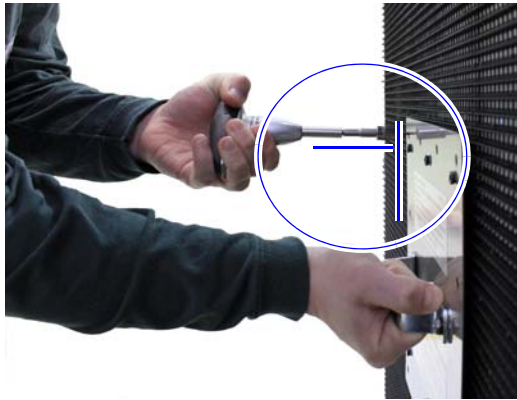

Correct use of torque wrench

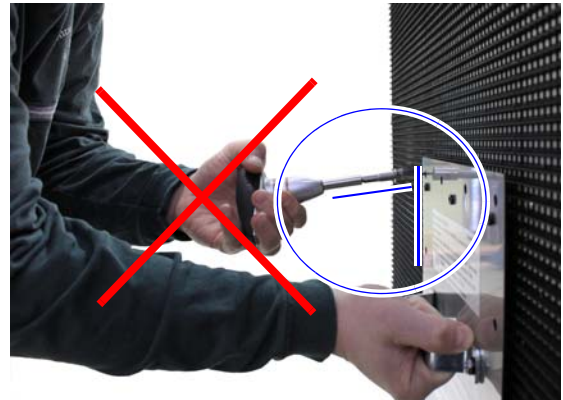

Incorrect use of torque wrench

WARNING

Torque wrench must be set to 4.5 inch-pounds and used perpendicular to the mask tool. Over torquing or incorrect use could damage the LED display module.

5. Connect power to the sign.