

SAFETY CRITICAL CHART	
LOC	DESCRIPTION
ALL	ALL HARDWARE SHALL BE TORQUED ACCORDING TO TORQUE SPECS

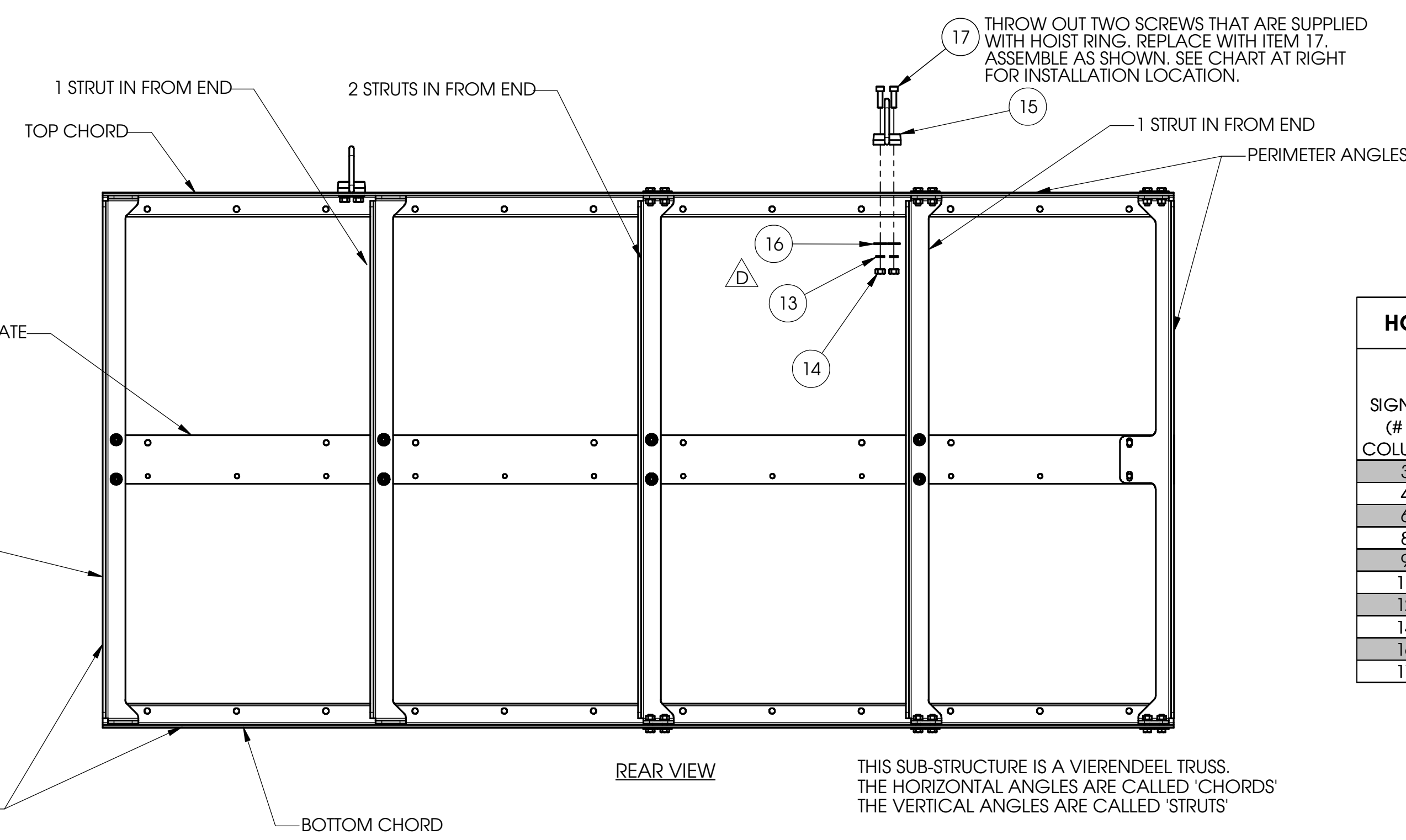
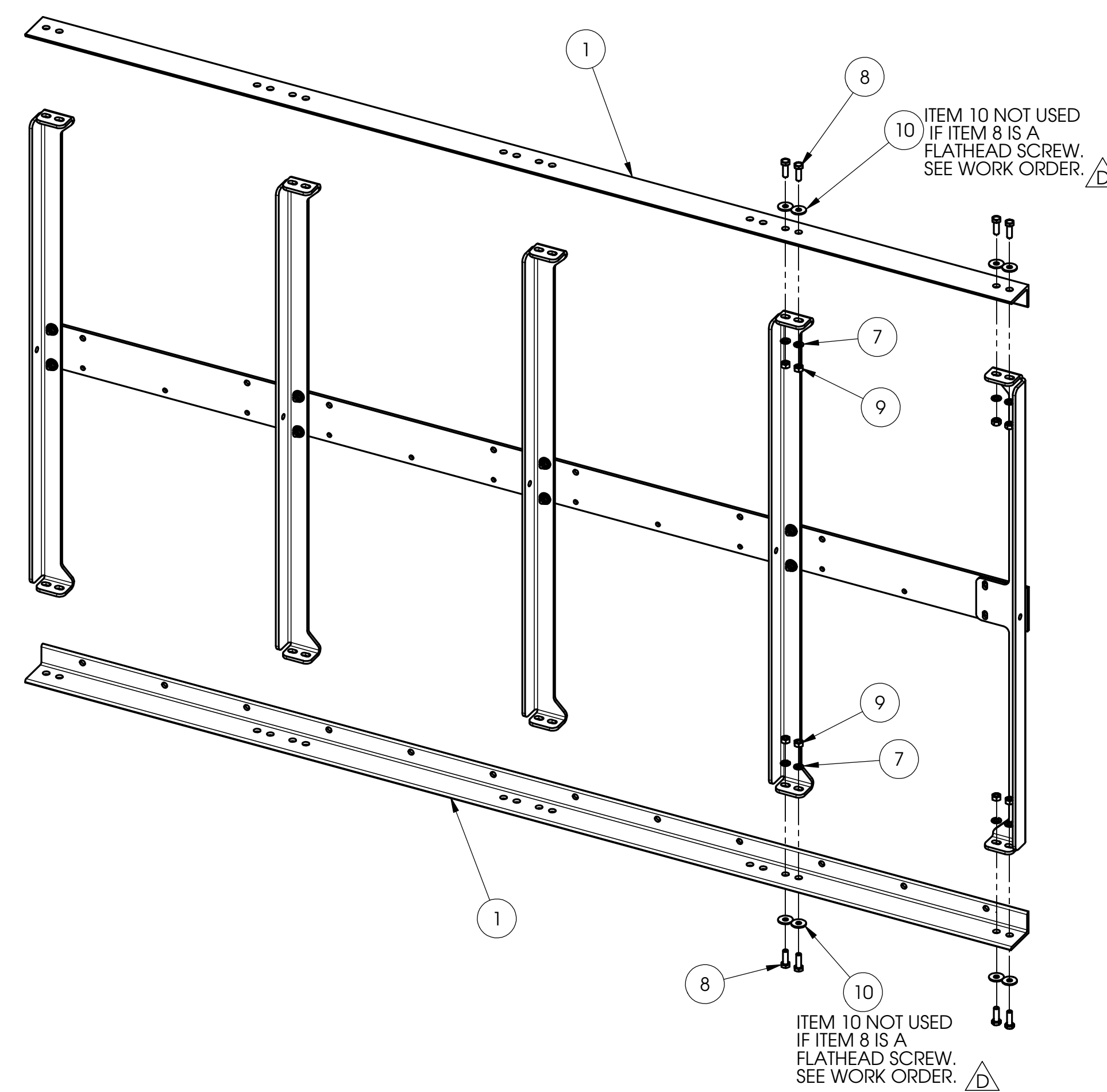
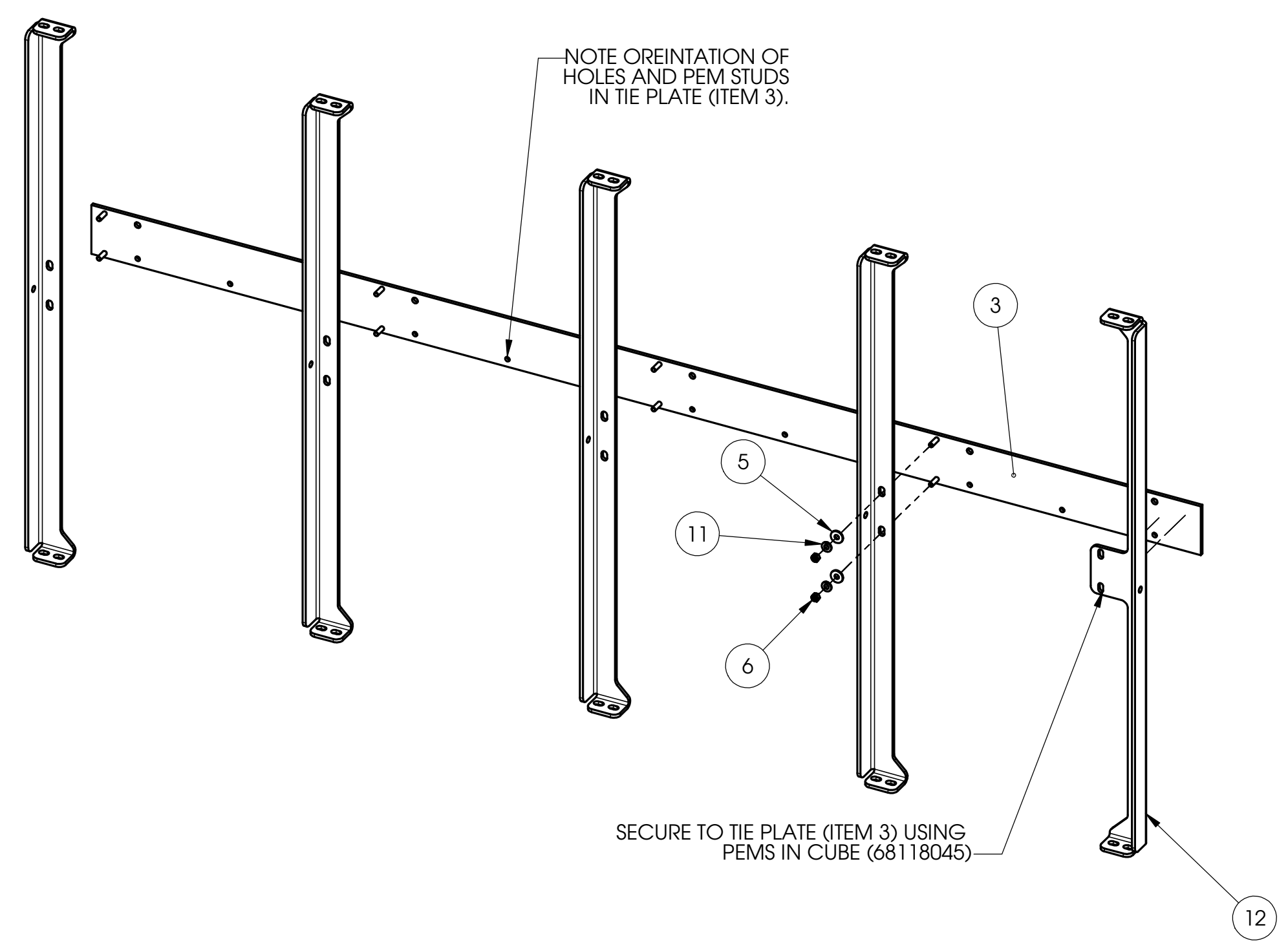

THIS SUB-STRUCTURE IS A VIENDEEEL TRUSS. THE HORIZONTAL ANGLES ARE CALLED 'CHORDS' THE VERTICAL ANGLES ARE CALLED 'STRUTS'

HOIST RING LOCATION

SIGN SIZE (# OF COLUMNS)	# OF HOIST RINGS	# OF STRUTS IN FROM THE ENDS (SEE REAR VIEW)
32	1	1
48	2	1
64	2	1
80	2	1
96	2	1
112	2	1
128	2	1
144	2	2
160	2	2
176	2	2

TORQUE SPECS ±10%	
SIZE	TORQUE LB-IN
M8	125
M10	250
3/8	540

BILL OF MATERIALS

ITEM NO.	PART NO.	DESCRIPTION
1	*	ANGLE,HORIZ,2X3X0.25,HR STEEL-A36,PAINT
2	*	ANGLE,VERT,2X2X0.25,HR STEEL-A36,PAINT
3	*	PLATE,HORIZ MNT,4X0.25,ALUM,PAINT BLK (CENTER BAR)
4	68118084	ANGLE,JOINT,REAR SUPPORT,P1180
5	61820036	WASHER,M8,18-8SS,24mmOD,2mm THK
6	62512610	NUT,HEX,LOCK,NYLON INSERT,M8,18-8 SS,BLK
7	61820031	WASHER,SPLIT LOCK,M10,18-8 SS,BLK OXIDE
8	*	SCREW,M10x1.5x30mm,18-8 SS,BLK OXIDE
9	61620026	NUT,TOP-LOCK,M10,HEX,18-8 SS, BLK OXIDE
10	61820034	WASHER,FLAT,M10,SS,10.5mmID,30mmOD,2.5mm
11	61820035	WASHER,SPLIT LOCK,M8,18-8 SS,BLK OXIDE
12	*	ANGLE,VERT,2X1.0X.25,HR STEEL-A36,PAINT
13	61811133	WASHER,LOCK,3/8,SPLIT-TYPE
14	61620027	NUT,3/8-16,HEX,GRADE 8,STEEL, ZINC,BLK
15	61910032	HOIST RING,3/8-16,2500 LB LOAD,STEEL,BLK
16	61820010	WASHER,FLAT,3/8,18-8 STAINLESS BLACK
17	61221169	SCREW,3/8-16x1.5,SH-CAP,GRADE 8,BLK ZINC

* SEE WORK ORDER
SEE WORK ORDER FOR QUANTITIES

REVERSED ITEMS 13 AND 16 IN EXPLODED DETAIL. ADDED NOTES FOR OPTIONAL TYPE ITEM 8. ADD TORQUE SPEC. UPDATED ITEMS 5 AND 6.		8359	SSL	11/20/03	DIMENSIONS ARE INCH AND TOLERANCES ARE AS FOLLOWS UNLESS OTHERWISE SPECIFIED: X ±0.1 XX ±0.02 XXX ±0.005 ANGLES ±1°		ADAPTIVE Adaptive Micro Systems LLC 7840 North 86th Street Milwaukee, WI 53224 USA
REMOVED VERTICAL STRUT ASSEMBLY DETAIL. ADDED HOIST RING NOTES.		8131	JES	9/25/03	DRAWN BY: SAA DATE: 4/14/03	TITLE: P1180 REAR STRUCTURAL SUPPORT ASSEMBLY	
ADDED TORQUE SPECS AND SAFETY CRITICAL CHART. ADDED SWIVEL HOIST RING. UPDATED SIGN. REMOVED DUAL DIMENSIONS. UPDATED TOLERANCES.		7992	SAA	5/14/03	CHECKED BY: SAA DATE: 4/14/03	SIZE: D DOCUMENT NO: 11800000-02 REVISION: D	
RELEASED FOR PRODUCTION		SAA		4/14/03	APPROVED BY: SAA DATE: 4/14/03	SCALE: 1:8 Released SHEET 1 of 1	