

1 Open the side of the sign labeled "CONTROLLER SIDE".

- Disconnect all power from the sign at the power source to prevent electrical injury or damage.
- Turn the controller-side panel latches counter-clockwise. Carefully raise the panel of the sign.

<p>AVERTISSEMENT TENSION DANGEREUSE. Plusieurs sources d'énergie peuvent être présentes. Risque de choc électrique. Débrancher toutes les sources d'alimentation avant tout entretien ou réparation.</p>		<p>WARNING HAZARDOUS VOLTAGE. Multiple power sources may be present. Risk of electrical shock. Disconnect all power sources before servicing.</p>
---	--	--

ADAPTIVE
800-719-2838
AVPG320112T2 - DS - W2K - X
SN: EN0001127
↓ CONTROLLER SIDE ↓

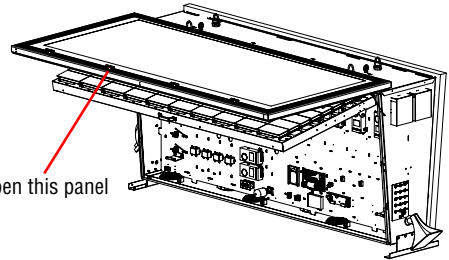

WARNING	
	<p>Possible fall hazard. Remain clear of door when opening.</p>

Open the panel identified as CONTROLLER SIDE on this label, attached to the bottom of the sign.

2 Connect the sign and messaging computer to an Ethernet network.

- Run Category 5 T568A or T568B wire from the network into the sign communications conduit.
- Position the wires into the channels on the modular network adapter (see below).
- Use a 110 punch-down tool to push the wires into the channels.
- Do not separate the twisted pairs more than 0.5 inches from the termination point.

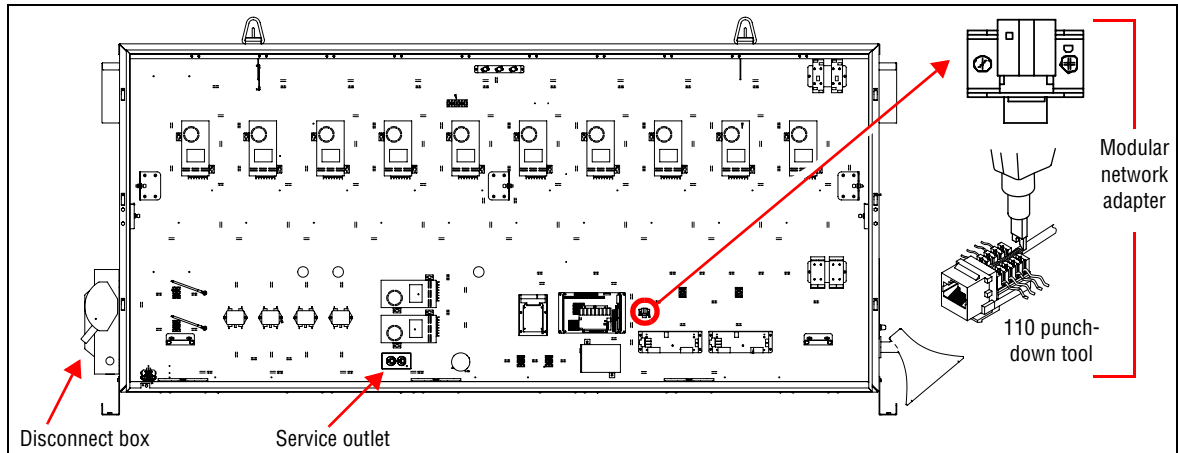

Category 5 T568A (8 wire)		Category 5 T568B (8 wire)	
110 type connector	RJ45 jack	110 type connector	RJ45 jack
Wht/Blu	5	Wht/Blu	5
Blu/Wht	4	Blu/Wht	4
Wht/Org	3	Wht/Org	1
Org/Wht	6	Org/Wht	2
Wht/Grn	1	Wht/Grn	3
Grn/Wht	2	Grn/Wht	6
Wht/Brn	7	Wht/Brn	7
Brn/Wht	8	Brn/Wht	8

Position the wires into the channels on the modular network adapter as shown below.

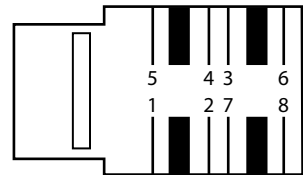

© Copyright 2004 Adaptive Micro Systems LLC. All rights reserved.
 Adaptive Micro Systems • 7840 North 86th Street • Milwaukee, WI 53224 USA • 414-357-2020 • 414-357-2029 (fax) • <http://www.adaptivedisplays.com>
 Trademarked names appear throughout this document. Rather than list the names and entities that own the trademarks or insert a trademark symbol with each mention of the trademarked name, the publisher states that it is using names for editorial purposes and to the benefit of the trademark owner with no intention of improperly using the trademark.
 The following are trademarks of Adaptive Micro Systems: Adaptive, Alpha, AlphaLert, AlphaNET, AlphaNet plus, AlphaEclipse, AlphaPremiere, AlphaTicker, AlphaVision, AlphaVision InfoTracker, Automode, BetaBrite, BetaBrite Director, BetaBrite Messaging Software, Big Dot, Director, EZ KEY II, EZ95, PagerNET, PPD, PrintPak, Serial Clock, Smart Alec, Solar, TimeNet.

The distinctive trade dress of this product is a trademark claimed by Adaptive Micro Systems LLC.
 Due to continuing product innovation, specifications in this manual are subject to change without notice.

3

If applicable, connect the speakers to the Tune Blaster sound cards.

- A sign may have up to 16 speakers. Each speaker should be 8 ohms and at least 10 watts.
- For each speaker, insert one non-metallic, compression type connector into a speaker conduit.
- Run speaker wire (Belden 8471 or equivalent) from each speaker through the connector to the sound card inside the sign.
- Connect the wires to the sound card using a #1 screwdriver (1/16" wide tip) to depress the spring clip and insert the speaker wire.

Inside a sign

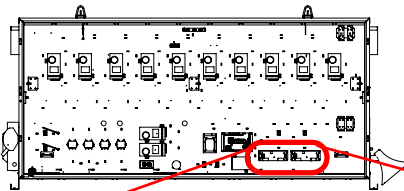

Each sign can support up to 16 speakers. There are 8 channels with two speakers (A and B) per channel.

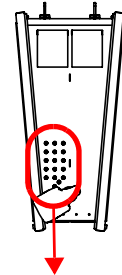

Speaker conduits on the side of the sign

Factory-installed sound card

Optional sound card

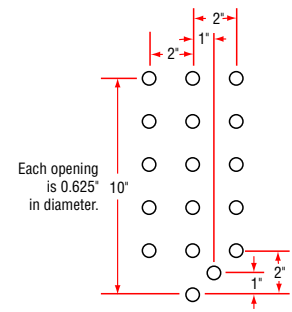
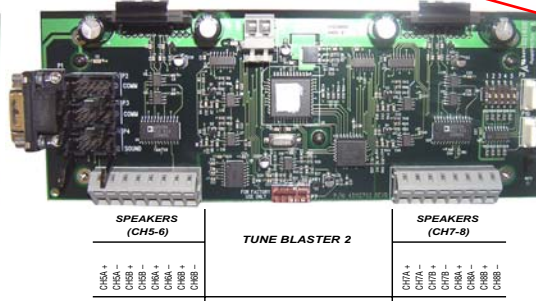
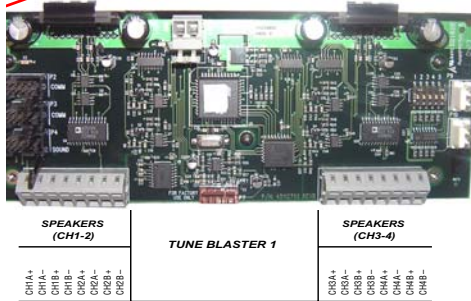

4

Close the sign.

- Carefully lower the panel.
- Turn the latches on the panel clockwise.



5

Connect power to the sign.

- Make sure that power is *not* applied at the power source.
- Run two 120VAC lines into the power conduit on the side of the sign with the disconnect box.
- Open the disconnect box.
- Connect the wires as shown below. Do not remove the yellow wires as they provide power to the fluorescent lighting circuit and service outlet. The fluorescent service light and service outlet are powered even when the disconnect box is open. The sign must be properly earth grounded.
- A two-pole disconnect device (supplied by the customer) must be installed in the building wiring for each branch circuit supplying the sign.
- Close the disconnect box. Apply 120VAC power at the power source. Then move the switch on the disconnect box up to the ON position.

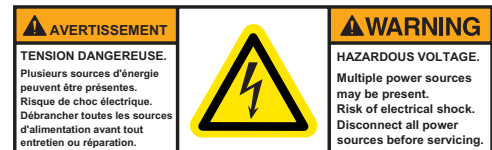

Side view

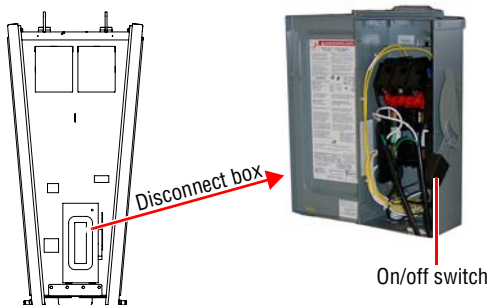

	Input Current (A)		
	Total	Master sign	Slave sign
¹ Rated Maximum	45.4	23.9	21.5
Maximum Operation	29.5	15.5	14.0
Typical Operation	11.4	6.0	5.4

¹These values represent the sign's maximum power usage which is calculated with every LED lit, all fans on, and all speakers operating.