

NOTES:
 1) TORQUE ALL FASTENERS PER DOCUMENT 10000016-01 UNLESS SPECIFIED ON DRAWING
 2) AS APPLICABLE TO THIS PART, THE FOLLOWING, BUT NOT NECESSARILY LIMITED TO: BASE MATERIAL, INTEGRATED FASTENERS, SURFACE TREATMENTS AND SURFACE COATINGS MUST COMPLY WITH THE REQUIREMENTS OF RoHS AS SPECIFIED IN ADAPTIVE MICRO SYSTEMS DOCUMENT #MS05.01 AND REACH DIRECTIVE AS SPECIFIED IN ADAPTIVE MICRO SYSTEMS DOCUMENT 10001031-01.

REV.	DESCRIPTION	ECO	BY	DATE
C	ADDED WATER TIGHT CAP (J53)	14803	JDW	2/14/2018
B	CHANGED DRILLED HOLE SIZE FROM Ø.125 TO Ø.813 FOR FORM COUPLER	14791	JDW	2/6/2018
A	RELEASED FOR PRODUCTION	-	JDW	05/10/2017

DIMENSIONS ARE INCH AND TOLERANCES ARE AS FOLLOWS UNLESS OTHERWISE SPECIFIED:				7840 North 88th Street Milwaukee, WI 53224 USA	
X	±0.1	DESIGNED BY	JDW	DATE	5/10/2017
XX	±0.02	DRAWN BY	JDW	DATE	5/10/2017
XXX	±0.008	SCALE	1:6	TITLE	DWG, KIT, A, J, L-SERIES, MONITOR VERSION
ANGLES	±1°	STATUS	Released	REVISION	C
SIZE D DOCUMENT NO. 17602514DR (SEE TABLE FOR PIN)		SCALE 1:6 STATUS Released		REVISION C 1 of 2	
<small>THIS DRAWING IS THE PROPERTY OF ADAPTIVE MICRO SYSTEMS LLC AND SHALL NOT BE DUPLICATED WITHOUT PERMISSION.</small>					

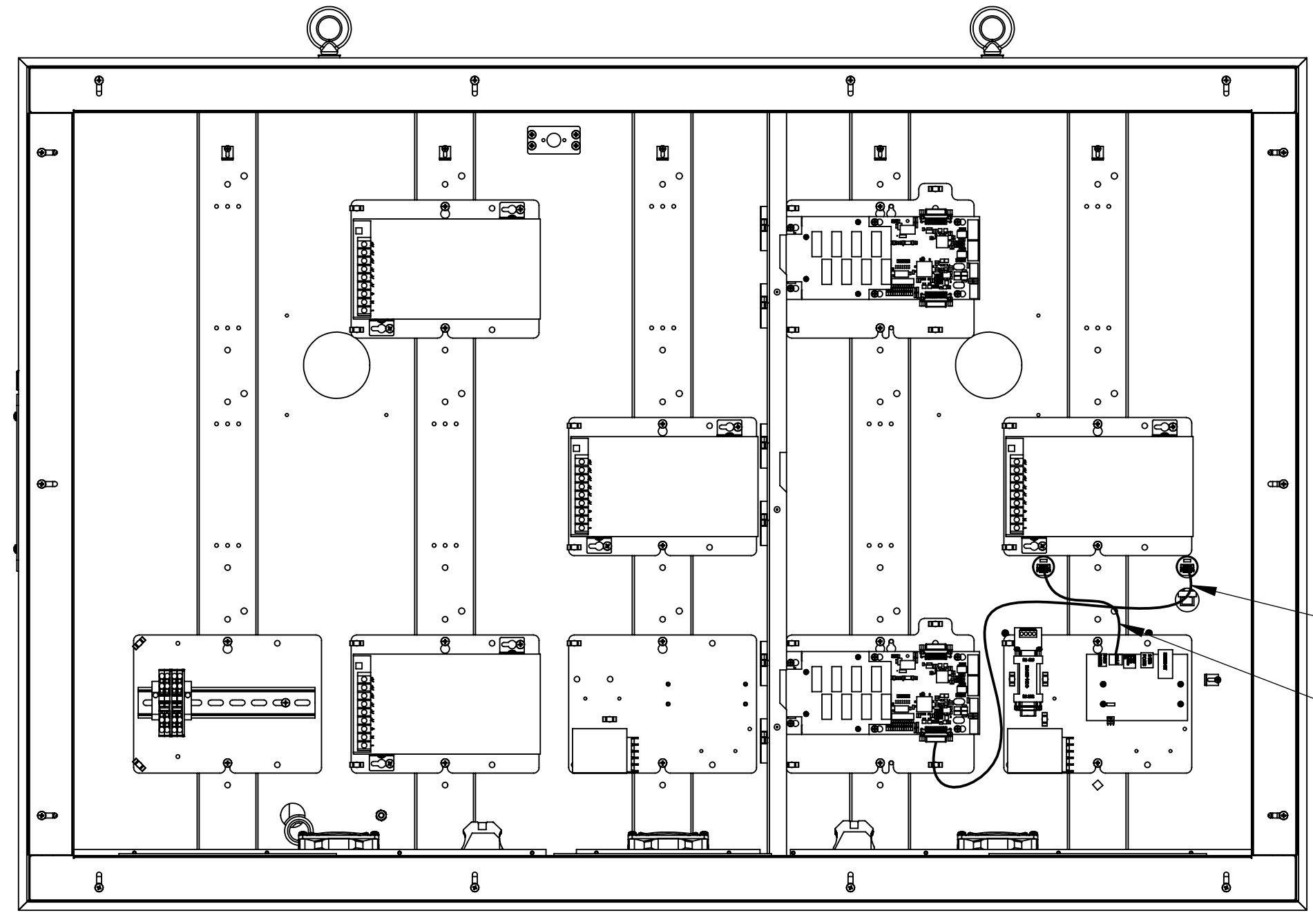
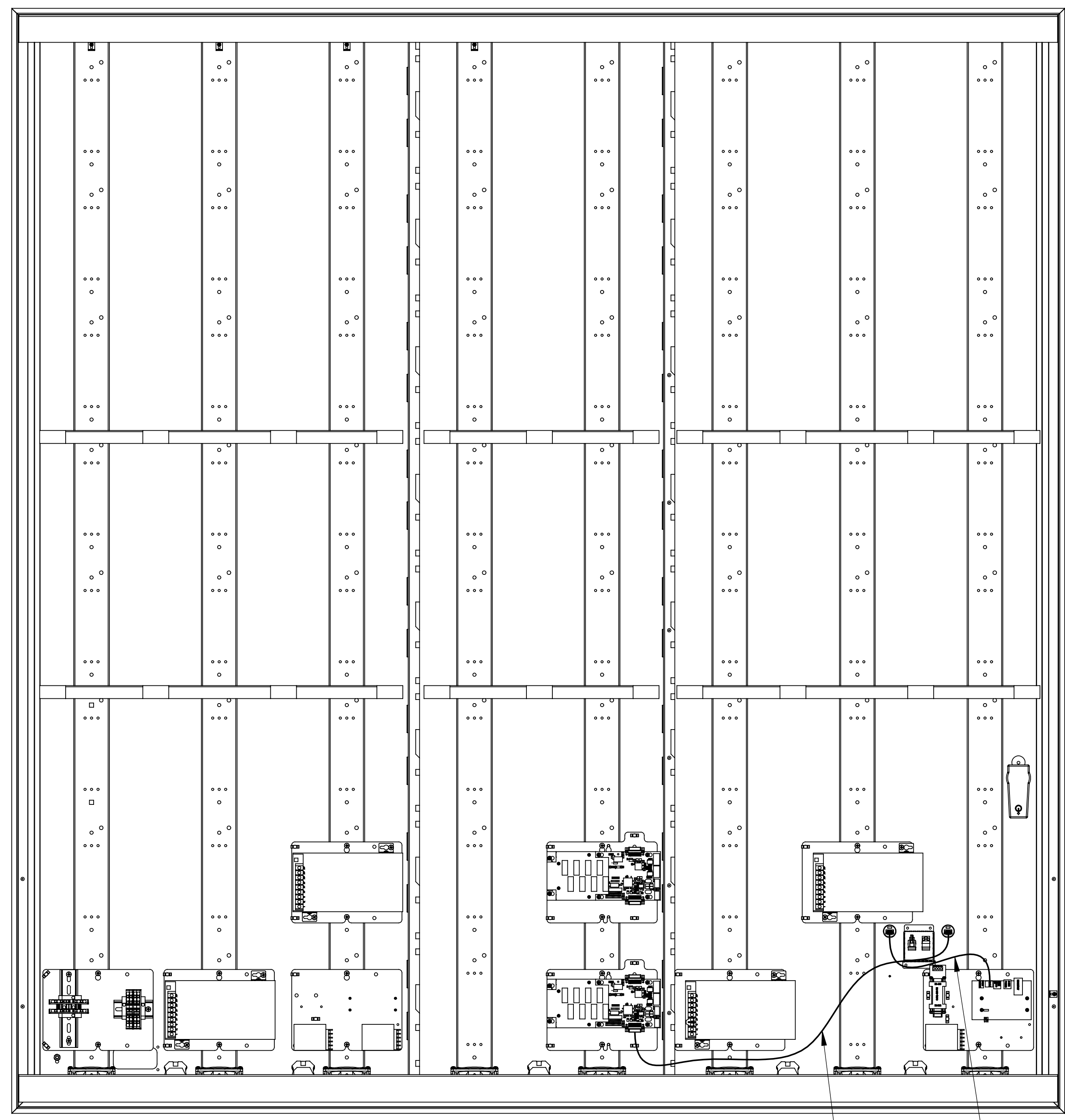
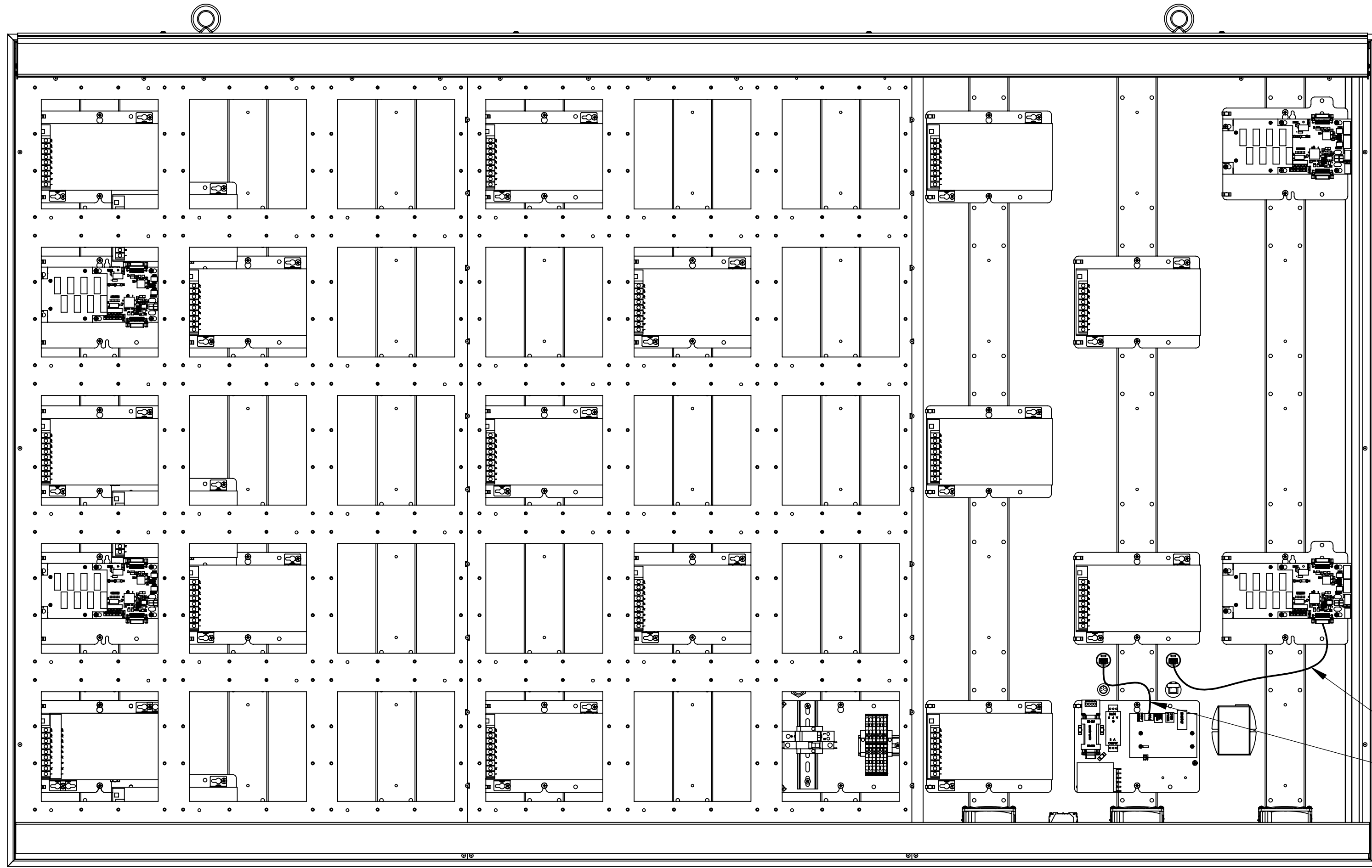

NOTES:
 1) TORQUE ALL FASTENERS PER DOCUMENT 10000016-01 UNLESS SPECIFIED ON DRAWING
 2) AS APPLICABLE TO THIS PART, THE FOLLOWING, BUT NOT NECESSARILY LIMITED TO: BASE MATERIAL, INTEGRATED FASTENERS, SURFACE TREATMENTS AND SURFACE COATINGS MUST COMPLY WITH THE REQUIREMENTS OF RoHS AS SPECIFIED IN ADAPTIVE MICRO SYSTEMS DOCUMENT #MS05.01 AND REACH DIRECTIVE AS SPECIFIED IN ADAPTIVE MICRO SYSTEMS DOCUMENT 10001031-01.

DIMENSIONS ARE INCH AND TOLERANCES ARE AS FOLLOWS UNLESS OTHERWISE SPECIFIED				7840 North 88th Street Minnetonka, WI 53224 USA	
X	±0.1	TITLE			
XX	±0.02	DWG, KIT, A, J, L-SERIES, MONITOR VERSION			
XXX	±0.008	DESIGNED BY	DATE	DOCUMENT NO.	REVISION
ANGLES	±1°	JDW	5/10/2017	(SEE TABLE FOR P/N)	C
		BROWN BY	DATE	SCALE	STATUS
		JDW	5/10/2017	1:6	Released
		APPROVED BY	DATE	SCALE	STATUS
				1:6	Released

THIS DRAWING IS THE PROPERTY OF ADAPTIVE MICRO SYSTEMS, LLC AND SHALL NOT BE REPRODUCED WITHOUT PERMISSION.