

Boost Regulator (pn 1179100401)

1.1 Description

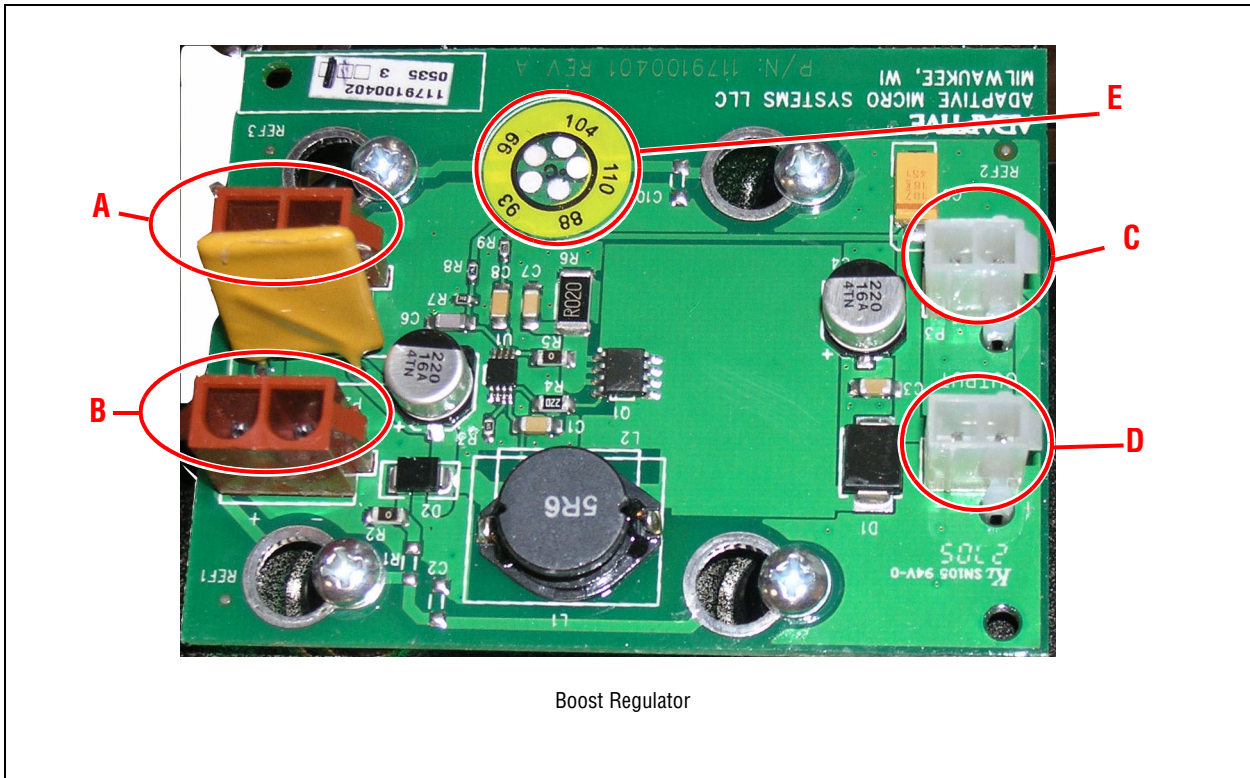

The boost regulator is used on the AlphaEclipse Street Smart 17X signs. With the boost regulator, voltage is stepped up from 5 volts to 9 volts for the controller board. There is only one boost regulator in a sign.



Boost Regulator

Item	Description
A	DC in from power supply.
B	DC out to display board.
C	Power output to the controller board.
D	Power output to communication options.
E	Temperature indicator used for diagnostics.

1.2 Installation instructions

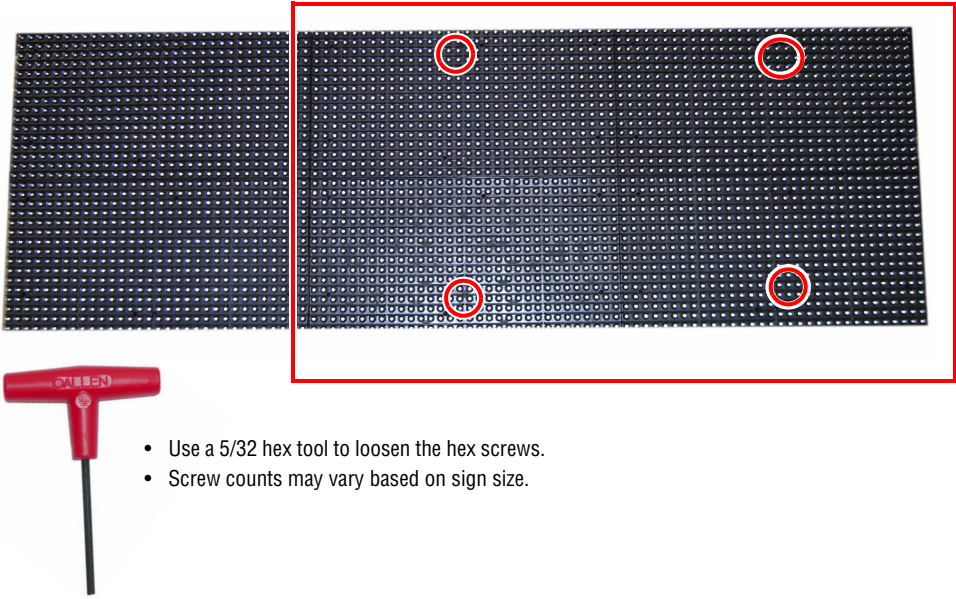
1	Prevent electrostatic discharge (ESD) or “static” damage to the replacement part. <ul style="list-style-type: none">For safe handling of ESD-sensitive parts, see TechMemo #00-0005.	 <p>ATTENTION OBSERVE PRECAUTIONS ELECTROSTATIC SENSITIVE DEVICE</p>
2	Remove power from the sign.	 <p>WARNING Hazardous voltage. Contact with high voltage may cause death or serious injury. Always disconnect power to unit prior to servicing. SM1000A</p>
3	Loosen the hex screws (circled below) for the controller section of the sign.  <ul style="list-style-type: none">Use a 5/32 hex tool to loosen the hex screws.Screw counts may vary based on sign size.	

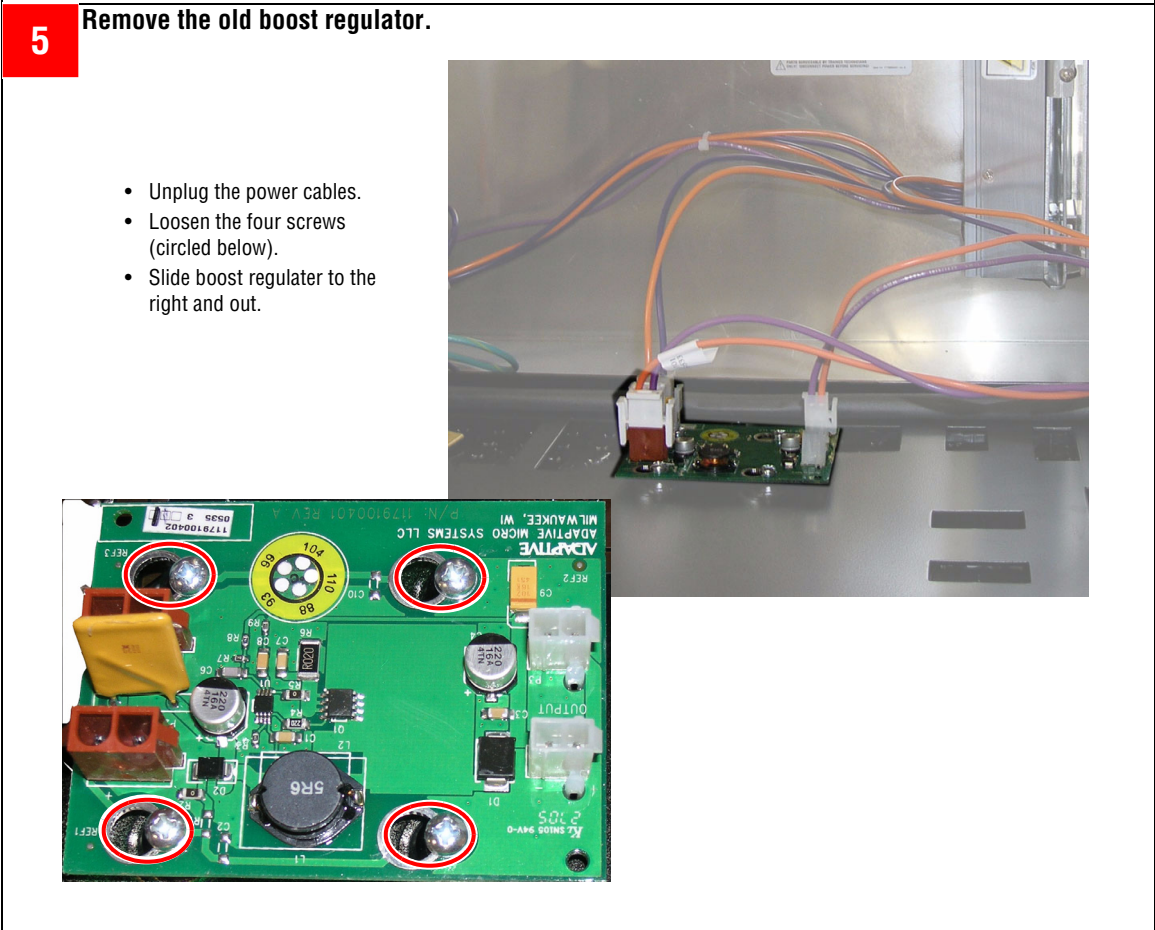
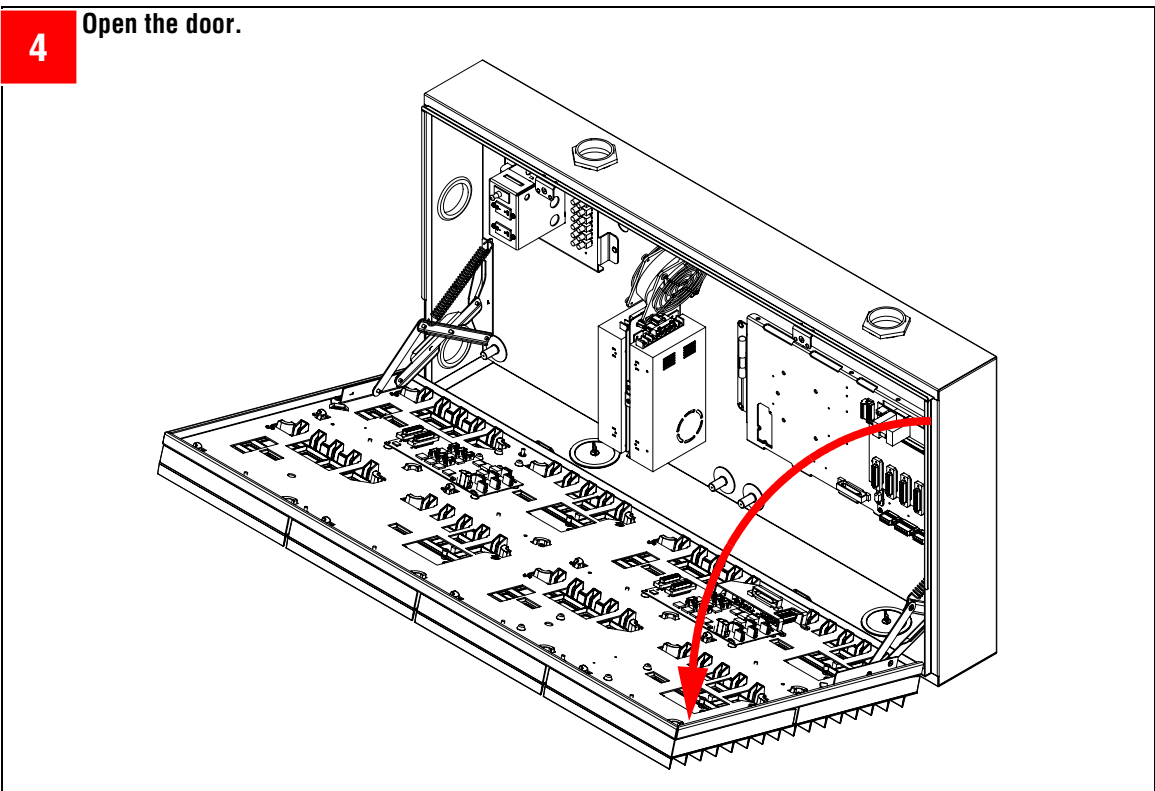

6	Place the new boost regulator in the sign. Tighten the screws and reattach the cables.
7	Close the sign door.
8	Reapply power to the sign.

ADAPTIVE[®]
Connecting people, places and ideas

© Copyright 2005 Adaptive Micro Systems, LLC. All rights reserved.
Adaptive Micro Systems • 7840 North 86th Street • Milwaukee, WI 53224 USA • 414-357-2020 • 414-357-2029 (fax) • <http://www.adaptivedisplays.com>

Trademarked names appear throughout this document. Rather than list the names and entities that own the trademarks or insert a trademark symbol with each mention of the trademarked name, the publisher states that it is using names for editorial purposes and to the benefit of the trademark owner with no intention of improperly using the trademark.

The following are trademarks of Adaptive Micro Systems: Adaptive, Alpha, AlphaLert, AlphaNET, AlphaNet plus, AlphaEclipse, AlphaPremiere, AlphaTicker, AlphaVision, AlphaVision InfoTracker, AlphaXpress, Automode, BetaBrite, BetaBrite Director, BetaBrite Messaging Software, Big Dot, Director, EZ KEY II, EZ95, PagerNET, PPD, PrintPak, Serial Clock, Smart Alec, Solar, TimeNet.

The distinctive trade dress of this product is a trademark claimed by Adaptive Micro Systems, LLC.
Due to continuing product innovation, specifications in this manual are subject to change without notice.



October 13, 2005

1179610501
